

# 4-wire Villa Video Intercom

## User Manual

by Elyssa Corp.

### Product Profile

This video door phone kit includes one outdoor station, one indoor monitor, one 15V power supply, and 4-pin connectors. This kit is an easy DIY installation for a single house, residential, and commercial building. You can add multiple entrances or multiple apartments, rooms, and monitors.

#### 1. All buttons' features

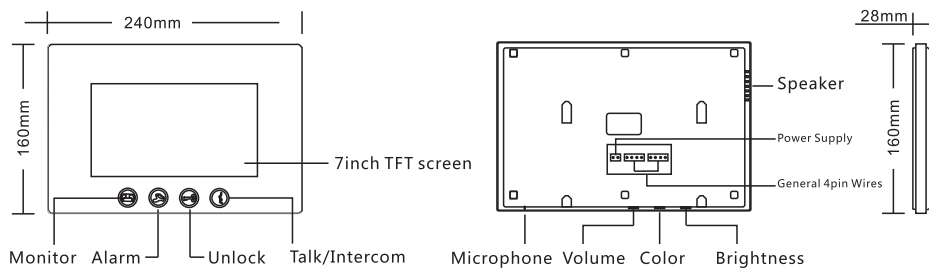

#### ● Outdoor Station



4 Cond. 24 AWG (RVV4\*0.5mm)

Please read this user manual carefully before installation

## 2. Operation Instructions

- 1. Visitors call:** Once the visitor pushes the Call button, it will light up the monitor ringing, and image of visitor will be shown in the monitor.
- 2. Intercom/Talk:** To answer the call from the outdoor station by pushing Talk/Intercom button will establish the conversation between the outdoor station and indoor station, to push Talk button again will hang off. If there is no one answering, the monitor will be closed after 45 seconds. If the time of conversation is over 45 seconds, the monitor will hang off automatically, but to push Monitor and Call button again will extend the conversation.
- 3. Alarm/ Unlock:** Under conversation, to push Unlock button will open the door. To keep pushing Alarm button will hear the Warning ring from the outdoor station that is to scare the stranger away.
- 4. Monitor:** Under standby, to push Monitor button will see what happened outside, and to push Monitor button again will exit.

## 3. Other Operations

### 1. How to set up the ringing volume of the monitor?

While on standby, hold the Monitor button until the monitor starts ringing. There are 6 levels of the ringing volume. Press the Monitor button to cycle through the levels. When you have the volume level you want, hold the Monitor button again to exit. Let go when the ringing stops.

## 4. Installation

### Indoor Station

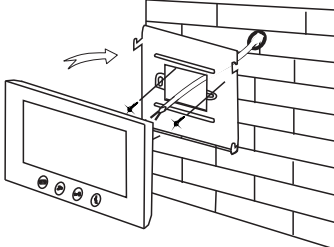
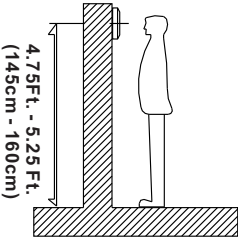
	
All monitors are surface-mounted, so to put the mounting bracket on the wall firstly will fix the monitor well.	The standard height of installing the outdoor station should be from 4.75 - 5.25 Ft. (145 - 160cm) away from the ground.

### Outdoor Station

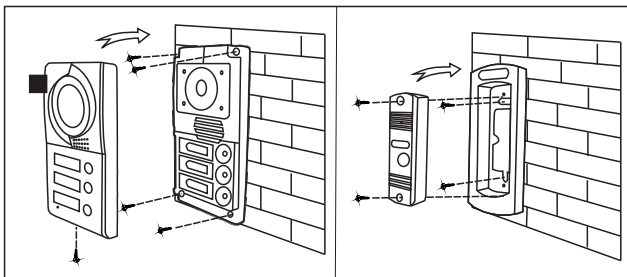

## 5. Diagrams

### Standard diagram of one outdoor station and one indoor station

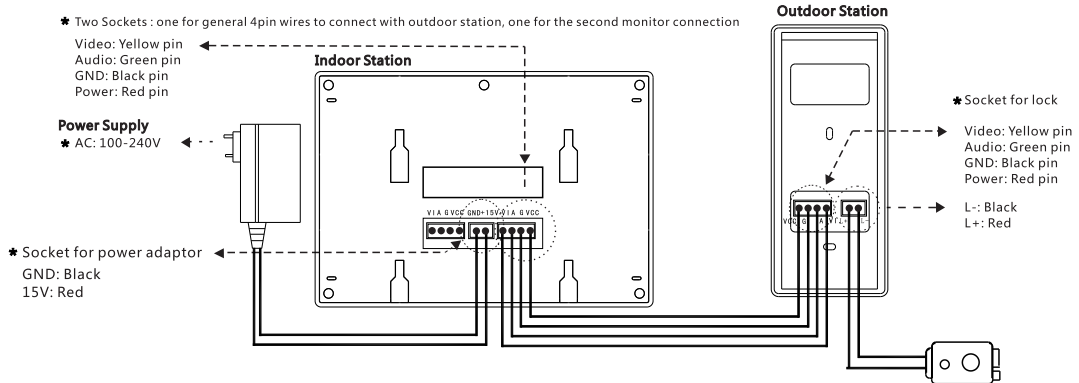

### Diagram of one button outdoor station

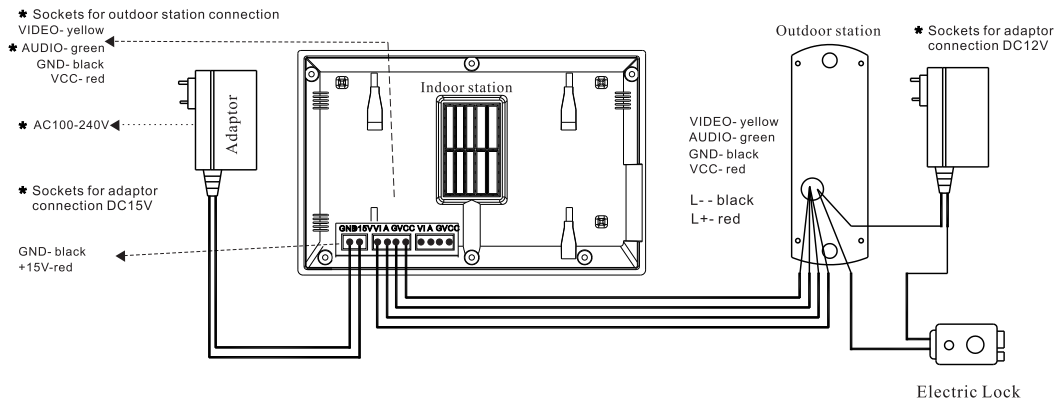

### Diagram of three button outdoor station

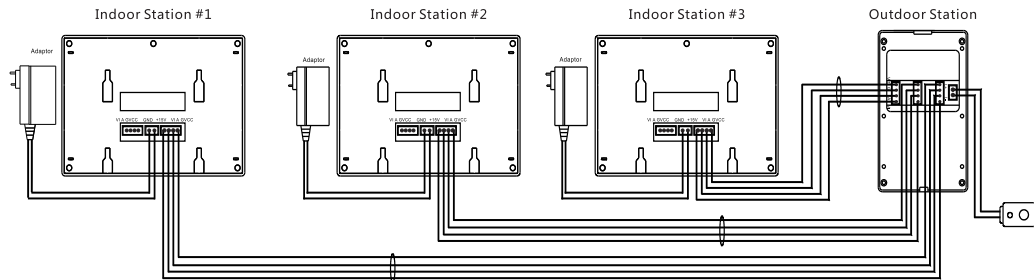

## 5. Diagrams

### Diagram of one outdoor station with 3 indoor stations

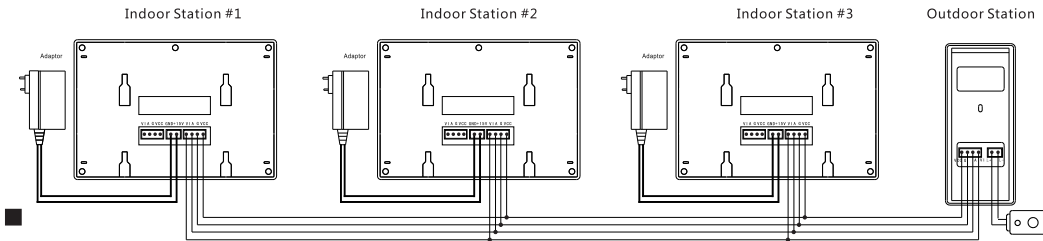

## 6. Cautions

1. Don't put the camera station under sunlight or other bright light.
2. The standard height of the installation is from 4.75 to 5.25 Ft. (145 to 165cm).
3. Keep outdoor station 10 Ft. (3 meters) away from the indoor station when testing before installation, in case of interference with the volume of the speaker.
4. Don't open the machine until the professional engineer comes.

### Wiring Requirements

Distance	Standard Cable
Up to 164 Ft. (50m)	4 Cond. 18 AWG
Up to 328 Ft. (100m)	4 Cond. 16 AWG

## 7. Technical parameters

Input Voltage	AC100~240V
Output Voltage	DC15V 1500mA
Power Consumption	Standby : $\leq 1W$ Working : $\leq 10W$
Cable	4 Cond. 18 AWG
Intercom Time	45 seconds
Working Temperature	-20°C ~ +60°C
Illumination	10 Ft. (3 meters) Night Vision

#### Standard Video Door Phone Kit

one outdoor station, one indoor station, one 15V power adaptor,  
a bag of screws, terminal cables and one user manual, color gift box.